

## Metric Threaded Spacers

Rigidly secure means of supporting PCB • Versatile with easy removal • Useful for stacking PC boards

For metric thread applications.

Nylon 6/6

### Male/Male

Length A mm	M2 Part No.	M3 Part No.	M4 Part No.
5.0	02-SMF205	02-SMF305	-
6.0	-	02-SMF306	*02-SMF406
8.0	02-SMF208	02-SMF308	*02-SMF408
9.0	-	02-SMF309	-
10.0	02-SMF210	02-SMF310	*02-SMF410
11.0	-	02-SMF311	02-SMF411
12.0	-	02-SMF312	02-SMF412
12.7	-	02-SMF313	-
15.0	02-SMF215	02-SMF315	02-SMF415
16.0	-	02-SMF316	02-SMF416
18.0	-	02-SMF318	02-SMF418
19.0	-	02-SMF319	02-SMF419
20.0	-	02-SMF320	02-SMF420
22.0	-	02-SMF322	02-SMF422
25.0	-	02-SMF325	02-SMF425
30.0	-	02-SMF330	*02-SMF430

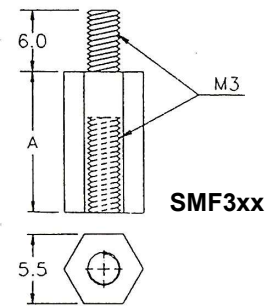

\*02-SMF4 are 7.0mm across flats, others are 6.0mm.  
02-SMF2 are 4.0mm across flats.

### Female/Female

Length A mm	M3 Part No.	M4 Part No.
6.0	02-MFF306	02-MFF406
8.0	02-MFF308	02-MFF408
10.0	02-MFF310	02-MFF410
11.0	02-MFF311	*02-MFF411
12.0	02-MFF312	02-MFF412
12.7	02-MFF313	*02-MFF413
15.0	02-MFF315	02-MFF415
16.0	-	*02-MFF416
17.0	02-MFF317	-
18.0	02-MFF318	02-MFF418
19.0	02-MFF319	-
20.0	02-MFF320	02-MFF420
22.0	-	-
25.0	02-MFF325	02-MFF425
30.0	02-MFF330	-
32.0	02-MFF332	-
52.0	02-MFF352	-

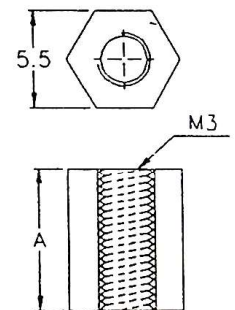
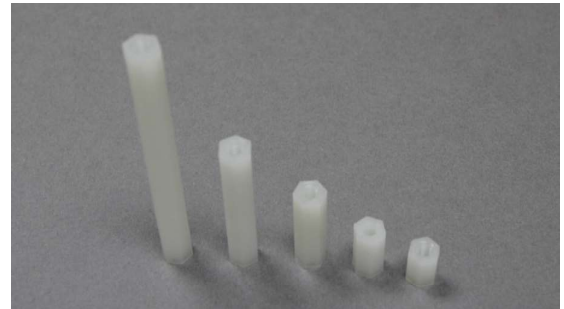

\*02-MFF4 are 7.0mm across flats, others are 6.0mm and continues thread to 5.5mm.

Note: Female/Female with lengths 19mm & longer, the thread is 9.5mm from each end and not continuous through.