

## Pop Rivets

Provide a simple method of securing two or more components together from one side

Part Number	A	B	C	D	E	Mounting Hole Ø	Chassis Thickness	Shear Force
04-PPRV3350B	3.2	6.4	6.4	1.4	2.1	3.3	1.0 - 4.0	20
04-PPRV3382B	3.2	9.6	6.4	1.4	2.1	3.3	4.0 - 7.0	20
04-PPRV33113B	3.2	12.7	6.4	1.4	2.1	3.3	7.0 - 10.0	20
04-PPRV4146B	4.0	6.4	8.0	1.8	2.4	4.1	1.0 - 4.0	25
04-PPRV4178B	4.0	9.6	8.0	1.8	2.4	4.1	4.0 - 7.0	25
04-PPRV41109B	4.0	12.7	8.0	1.8	2.4	4.1	7.0 - 10.0	25
04-PPRV48124B	4.8	14.4	9.6	2.0	2.8	4.9	8.0 - 11	40
04-PPRV4860	4.8	8	9.6	2.0	2.8	4.9	1.5 - 5.0	40
04-PPRV4892B	4.8	11.2	9.6	2.0	2.8	4.9	5.0 - 8.0	40
04-PPRV57105B	5.6	12.7	12	2.2	3.4	5.7	5.5 - 8.5	65
04-PPRV57137B	5.6	15.9	12	2.2	3.4	5.7	8.5 - 12	65
04-PPRV5774B	5.6	9.6	12	2.2	3.4	5.7	2.0 - 5.5	65

**Material: Polycarbonate**  
**Black / Clear**

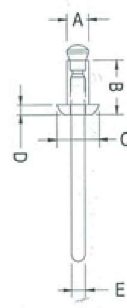

## Blind Rivets

The three leg design securely locks the panels in place and prevents pullout

Part Number	A	B	C	D	L	Mounting Hole Ø	Chassis Thickness
04-PPRV6328C	6.1	28.0	2.4	16.8	55.80	6.3	3.9 - 10.0
04-PPRV6328D	6.1	28.0	2.4	12.9	55.06	6.3	3.9 - 10.0

**Material:**  
**Body: Nylon 6/6**  
**Pin: Acetal**

