

## Plastic Line | Stainless Steel

### Black Polyamide Plastic Base 50 Diameter - 30 Degree Articulated Stainless Steel Screw

Static Load 11000 Newton • 15 Socket • Non-Skid NBR Rubber 70 shore pads available

Part no. Base	Part no. Screw	Screw	S	B	D	Adjust	F	G	H
11-FBP15-50	11-ASSS15-10-050	M10X50	30	50	50	14	M10	20	80
11-FBP15-50	11-ASSS15-10-100	M10X100	30	100	50	14	M10	20	130
11-FBP15-50	11-ASSS15-10-125	M10X125	30	125	50	14	M10	20	155
11-FBP15-50	11-ASSS15-12-075	M12X75	30	75	50	14	M12	20	105
11-FBP15-50	11-ASSS15-12-100	M12X100	30	100	50	14	M12	20	130
11-FBP15-50	11-ASSS15-12-125	M12X125	30	125	50	14	M12	20	155

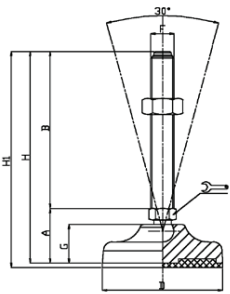

Two piece part

### Black Polyamide Plastic Base 65 Diameter - 30 Deg. Articulated Stainless Steel Screw

Static Load 11000 Newton • 15 Socket • Non-Skid NBR Rubber 70 shore pads available

Part no. Base	Part no. Screw	Screw	S	B	D	Adjust	F	G	H	Load
11-FBP15-65	11-ASSS15-10-050	M10X50	33	50	65	14	M10	23	83	1100 Newton
11-FBP15-65	11-ASSS15-10-100	M10X100	33	100	65	14	M10	23	133	
11-FBP15-65	11-ASSS15-10-125	M10X125	33	125	65	14	M10	23	158	
11-FBP15-65	11-ASSS15-12-075	M12X75	33	75	65	14	M12	23	108	
11-FBP15-65	11-ASSS15-12-100	M12X100	33	100	65	14	M12	23	133	
11-FBP15-65	11-ASSS15-12-125	M12X125	33	125	65	14	M12	23	158	
11-FBP15-65	11-ASSS15-16-075	M16X75	37	75	65	14	M16	23	112	1500 Newton
11-FBP15-65	11-ASSS15-16-100	M16X100	37	100	65	14	M16	23	137	
11-FBP15-65	11-ASSS15-16-125	M16X125	37	125	65	14	M16	23	162	
11-FBP15-65	11-ASSS15-16-150	M16X150	37	150	65	14	M16	23	187	
11-FBP15-65	11-ASSS15-16-175	M16X175	37	175	65	14	M16	23	212	
11-FBP15-65	11-ASSS15-20-100	M20X100	37	100	65	14	M20	23	137	
11-FBP15-65	11-ASSS15-20-150	M20X150	37	150	65	14	M20	23	187	
11-FBP15-65	11-ASSS15-20-175	M20X175	37	175	65	14	M20	23	212	
11-FBP15-66	11-ASSS15-20-200	M20X200	37	200	65	14	M20	23	237	

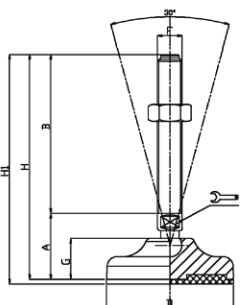

Two piece part