

4121 – Male/Male Anti-Vibration Mount

Rubber SBR 60° / 65° shore A & Zinc plated Steel • Thermoplastic Body

Part Number	D	h	e	d	s	Cp	Cz
11-AVMM1210S5	13	10	10	M5	1.5	15	2
11-AVMM1515S4**	15	15	14	M4	1.5	15	2
11-AVMM2010S6	20	10	16	M6	1.5	36	3
11-AVMM2015S6	20	15	16	M6	1.5	34	4
11-AVMM2020S6	20	20	16	M6	1.5	34	3
11-AVMM2520S6	25	20	18	M6	2	45	5
11-AVMM2530S6	25	30	18	M6	2	34	3
11-AVMM3020S8	30	20	23	M8	2	66	9
11-AVMM3030S8	30	30	23	M8	2	61	7
11-AVMM3038S8	30	40	23	M8	2	55	5
11-AVMM4030S8	40	30	23	M8	2	98	15
11-AVMM4035S8	40	35	23	M8	2	88	13
11-AVMM5020S10	50	20	27	M10	3	168	21
11-AVMM5030S10	50	30	28	M10	3	158	19
11-AVMM5040S10	50	40	28	M10	3	143	17
11-AVMM5050S10	50	50	28	M10	3	133	13
11-AVMM6550S12	65	50	37	M12	2	230	23
11-AVMM7525S12	75	25	37	M12	3	382	89
11-AVMM7540S12	75	40	37	M12	3	377	79
11-AVMM7550S12	75	50	37	M12	3	372	69
11-AVMM10050S16	100	50	46	M16	3	560	99
11-AVMM10055S16	100	55	45	M16	4	635	79
11-AVMM10060S16	100	60	46	M16	4	700	50

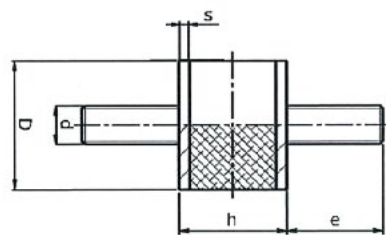

* Cp Maximum load compression (kg)

* Cz Maximum load shear (Kg)

**Available in stainless steel

4117 – Anti-Vibration Mount - Tapered

Rubber SBR 60° / 65° shore A & Zinc plated Steel • Used as shock-absorbers, feet and stroke end

Part Number	D	h	e	d
11-AVMT2530S6	25	30	18	M6
11-AVMT3040S8	30	40	23	M8
11-AVMT4050S8	40	50	23	M8
11-AVMT5055S10	50	55	27	M10
11-AVMT7570S12	75	70	37	M12
11-AVMT10085S16	100	85	46	M16

